



Dodge Engineering & Controls, Inc.

Call Toll Free: **877-DEI-CTRL (877) 334-2875**

Since its inception in 1982, Dodge Engineering & Controls (DEI) has strived to maintain a reputation for unsurpassed value, reliability and professional engineering assistance. Over the years, our organization has grown and our product line has expanded to over 30,000 combinations. In July 2000 DEI proudly became Dodge Engineering & Controls, Inc.. However, our philosophy of '**customer service first**' has remained unchanged.



Today, we are a professional engineering and manufacturing company specializing in control valves, dampers and air actuation products for a wide variety of applications. Our engineering and sales staff has decades of commercial and industrial automation and flow control experience. Let us meet all your flow control needs.

DEI Offers "*The Complete Solution*" in AIR and FLUID Control

A wide selection of Dampers, Commercial and Industrial Actuators, and Control Valves
Electric / Electronic / Pneumatic

Air / Hot Water / Chilled Water / High & Low Pressure Steam / Refrigeration / Process Control

Ball: Screwed, Flanged & Grooved



- Two & Three Way Bodies Available
- Equal % Type and other Flow Characteristics Available
- Bronze, Stainless Steel and Carbon Steel Bodies
- Wide selection of seat and seal materials
- DEI high performance stem seals provide ten times the modulation life of standard seals

- Cv's from 0.5 to 23,780
- High Close-Off Capabilities
- 2 & 3 Piece bodies: 3/8" - 12"
- Stainless Steel Ball and Stem (Recommended)
- Chrome Plated Ball w/ Bronze Stem (Available)
- Special Hi/Low Temp. Assemblies in stock



Globe, Zone & Terminal Valves:



- Equal %, Mod. Equal % and Linear Flow Profiles
- Bronze or Stainless Steel Trim Available
- Mixing or Diverting Configurations Available
- Bronze, Cast Iron, Stainless and Carbon Steel Bodies

- Cv's from 0.4 to 1649
- Single or Double Seated for High Close-Off
- ANSI Class 125 through 600
- Zone & Terminal Valves - High Close-Off and compact size



Butterfly: Wafer, Semi-Lugged, Full-Lugged, Grooved End, Resilient Seated, Metal Seated & High Performance



- Two Way and Three Way Configurations
- Aluminum-Bronze, Nylon II Coated & Stainless Steel Discs
- Full and Reduced Discs Available
- Cast Iron, Ductile Iron, Stainless Steel and Carbon Steel Bodies Available

- Cv's from 60 to 52,000
- ANSI Class 125, 150, 300 & 600
- EPDM Seats (BUNA-N and Viton® Available)





Dodge Engineering & Controls, Inc.

Call Toll Free: 877-DEI-CTRL (877) 334-2875

Actuators: Damper Applications, Valve Assemblies & Retrofit Applications

- Commercial, Industrial (with current limiting), Process Control & Various NEMA Types Available
- Electronic - Spring Return, Two Position, Tri-State (Floating) & Modulating (0-10 V, 2-10 V, 0-20 mA, 4-20 mA, 0-135 Ω, 100-10,000 Ω, PWM, 0-20 V Phasecut)
- Pneumatic - Double Acting, Spring Return, Two Position & Modulating (3-15 psi, 0-10 V, 4-20 mA)



Dampers

- Commercial Control
- Thermally Insulated Control
- Air Flow Measuring Control
- Industrial Control
- Smoke, Fire/Smoke, Fire
- Marine



- Manual Balancing
- Backdraft
- Ceiling Radiation
- Louvers, Combination Louver/Damper
- Access Doors
- And many more models

Control Valve Retrofits: Ball, Globe & Butterfly

- High & Low Temperature Applications
- Standard Retrofit Globe Valve Linkages for all Major Manufacturers of Valve Bodies
- Custom Retrofits available for Ball, Globe & Butterfly Valves

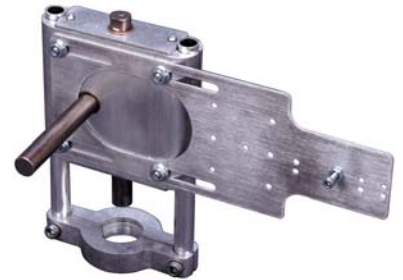

Professional Engineering:

- Assistance & Solutions for all your Flow Control Applications
- Free Technical Training Seminars (On-Site or In-House)
- Consulting & Field Support

Corporate Headquarters & Manufacturing

DEI - Dodge Engineering & Controls, Inc.
 196 Riverneck Road
 Chelmsford, MA 01824 USA
 Website www.DEIcontrols.com

For More Information Contact:

Toll Free 877-DEI-CTRL

Phone: (978) 244-1200

Fax: (978) 244-1422

E-mail: Mail@DEIcontrols.com